

SPECIFICATIONS	N99-342HTRSI	N102-342HTRI N110-342HTRI N120-342HTRI	N102-362HTRI N110-362HTRI N120-362HTRI	N102-402HTRI N110-402HTRI N120-402HTRI
Recommended horsepower (HP PTO)	100 to 200	125 to 225	175 to 350	250 to 350
Cutting width (in/mm)	99" 2515	102" / 110" / 120" 2591 / 2794 / 3048	102" / 110" / 120" 2591 / 2794 / 3048	102" / 110" / 120" 2591 / 2794 / 3048
Cutting height (in/mm)	48" 1219	53" 1346	55" 1397	60" 1524
Impeller RPM	540	540	540	540
Snowremoval capacity ton/hour (up to)	1 500	1 700	2 550	3 100
Removable rotary drum in Hardox 450 steel	Std	Std	Std	Std
Impeller Depth (in/mm)	14 ¼" 362	16" 406	16" 406	16" 406
Drum contour in Hardox 450 steel (in/mm)	Std ¼" 6	Std ¾" 10	Std ¾" 10	Std ¾" 10
Drum center height (in/mm)	21" 533	21 ¼" 540	22 ¼" 565	24 ¼" 616
Impeller shaft diameter (in/mm)	2" 51	2" 51	2 ½" 64	2 ½" 64
Impeller diameter (in/mm)	34" 864	34" 864	36" 914	40" 1016
Number of blades	5	5	5	5
Impeller in Hardox 450 steel	Std	Std	Std	Std
Balanced impeller	Std	Std	Std	Std
Main auger diameter (in/mm)	23" 584	30" 762 double bolted ribbon	30" 762 double bolted ribbon	30" 762 double bolted ribbon
Upper auger diameter (in/mm)	17" 432	16" 406	16" 406	20" 508
Balanced auger	Std	Std	Std	Std
Teeth in Hardox 450 steel on augers	Std	Std	Std	Std
Hydraulic chute rotation by hydraulic motor	Std	Std with reducer	Std with reducer	Std with reducer
Semi industrial chute (2 deflectors)	Opt	Opt.	Opt.	Opt.
Hydraulic telescopic chute	Opt	Opt	Opt	Opt
Telescopic chute – articulated deflectors	-	Opt	Opt	Opt
Chute on left or on right	Right	Left	Left	Left
Hydraulic cylinder – deflector action (in/mm)	2 ½" x 8" 64 x 203	2 ½" x 8" 64 x 203	2 ½" x 8" 64 x 203	2 ½" x 8" 64 x 203
Lights support on telescopic chute (2)	Opt.	Opt	Opt	Opt
Reversible cutting edge in Hardox 450 steel	Std	Std	Std	Std
Fixed lateral blades	Std	Std in Hardox 450 steel	Std in Hardox 450 steel	Std in Hardox 450 steel
Hydraulic lateral blade in Hardox 450 steel	-	Opt	Opt	Opt
Removable lateral skid shoes in Hardox 450	Std	Std	Std	Std
Adjustable wheels (2 x 2)	-	Std	Std	Std
Sidewalk chain diverter in Hardox 450 steel	-	1x Std / 1x opt.	1x Std / 1x opt.	1x Std / 1x opt.
Truck / Guardrail diverter in Tivar	-	1x Std	1x Std	1x Std
Driving chain	100	Renold 100 HV	Renold 100 HV	Renold 100 HV
Clutch on driving shaft	-	Std	Std	Std
Number of safety bolt	3	1 (PTO)	1 (PTO)	1 (PTO)
Bearing ductile iron casing	Std	Std	Std	Std
PTO Shaft	V80 or V90	V80 or V90	V90 or W2600 (clutch)	V90 or W2600 (clutch)
Reducer box 1 000 / 540 RPM	Opt	Std	Std	Std
Auxiliary tank	-	Std	-	-
Forced lubrication system on reducer box	-	-	Std	Std
Hitch category (QH = Quick hitch)	2, 2 QH	2, 2 QH	2, 2 QH	3, 3 QH
Approx weight (lb/kg)	3 350 / 1520	4 365 / 4 505 / 4 645 1980 / 2043 / 2107	4 690 / 4 840 / 4 990 2127 / 2195 / 2263	4 930 / 5 085 / 5 240 2236 / 2307 / 2377

The weight includes the standard equipments and telescopic chute

WARRANTY

Every product manufactured by Normand Co. Ltd is guaranteed against manufacturing and raw material defects (excluding the P.T.O, shafts, gearboxes, engines, hydraulic motors, hydraulic cylinders, telescopic cylinders, tires, hubs and wheels, which are covered by the manufacturer warranty) for a full year from the date of purchase, provided that the product has not been modified or abused in any way. This warranty does not cover accidents or breaks caused by objects other than snow (metal bits, concrete, wood, asphalt, tires, etc.). Also blades, skid shoes, soles of skid shoes, driving chains and tires wear is not covered by the warranty. We will replace or repair any defective part at no cost if they are returned prepaid at our plant in Saint-Pascal (Kamouraska, Québec, Canada). Our obligations are limited to the replacement and/or repair of the defective part.

HARDOX®
IN MY BODY



NORMAND®

LA PERFORMANCE ATTACHÉE À VOS TRACTEURS



Specifications are subject to change without notice.

DEALER

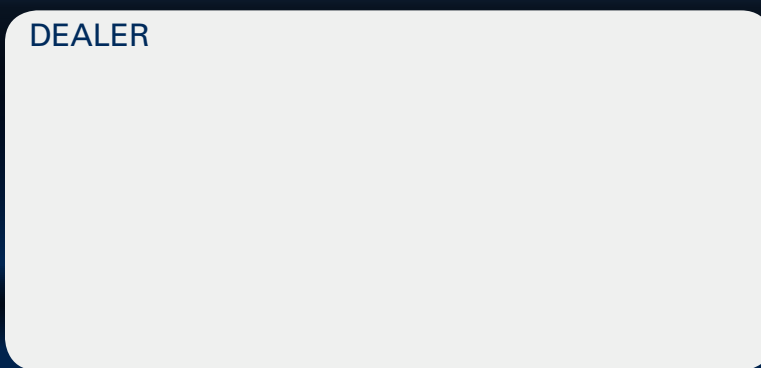

NORMAND®
HITCH YOUR TRACTOR TO HIGH PERFORMANCE



Normand Co. Ltd
340, Tache Street
Saint-Pascal (Quebec) Canada G0L 3Y0
T : 418 492-2712
1 888 666-7626
F : 418 492-9363
E-mail : normand@cienormand.com
www.cienormand.com
www.facebook.com/cienormand

Printed Canada © 2022

© Normand® Co. Ltd 2022 All Rights Reserved

SNOWBLOWERS INDUSTRIAL

The various models of industrial snowblowers manufactured by NORMAND have all been designed and built to offer you a high-quality product that proves to be robust and reliable, thus delivering extraordinary performance and durability.

The multiple options available ensure optimum output from your equipment, regardless of your snow-removal duties.



Semi industrial chute



Left exit of the rotary drum



Working lights on telescopic chute

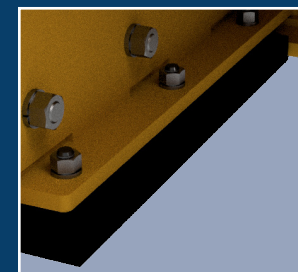

Lateral skid shoes in Hardox 450 steel

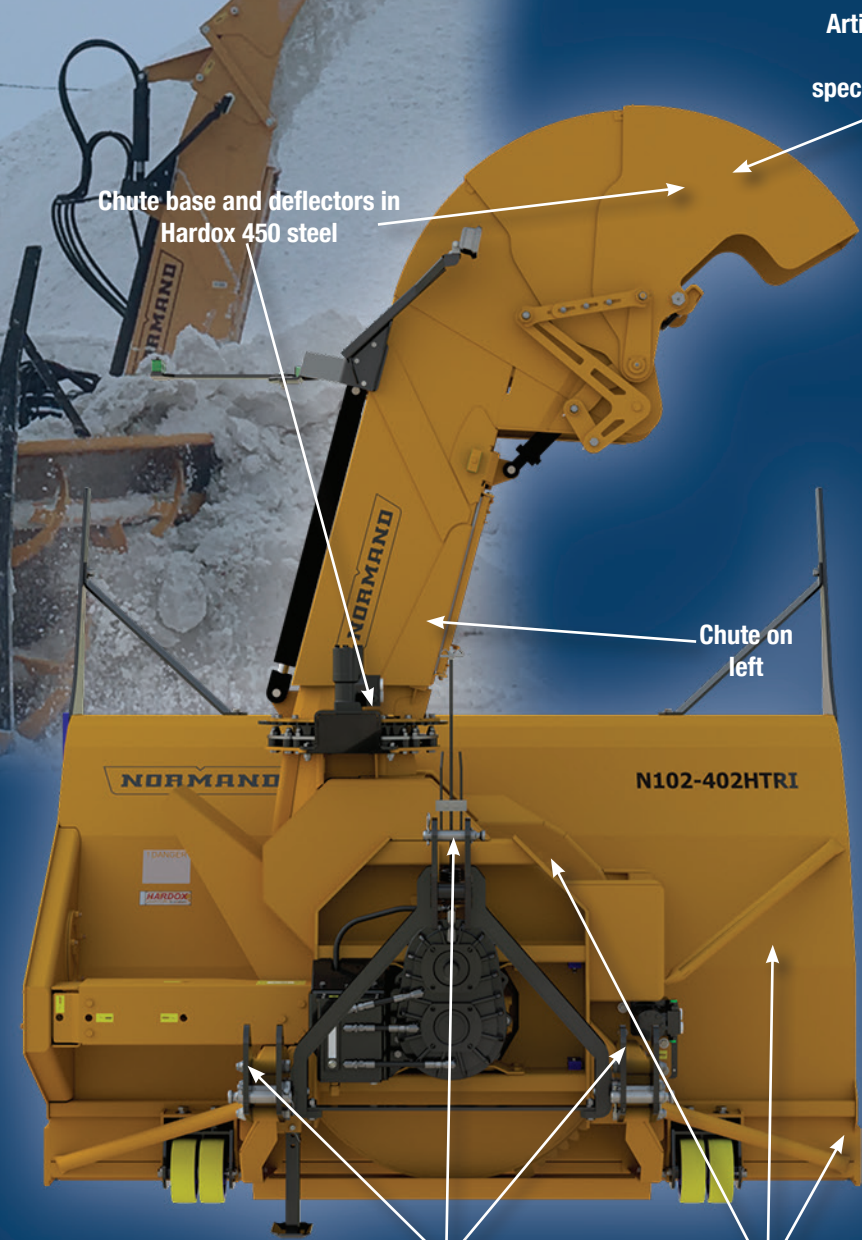

Chute base and deflectors in Hardox 450 steel

Articulated telescopic industrial chute specific for truck loading

Chute on left

3-pts in Hardox 450 steel Category 2 or 3 and standard quick hitch

Frame, sides, reinforcement sides and drum in Hardox 450 steel

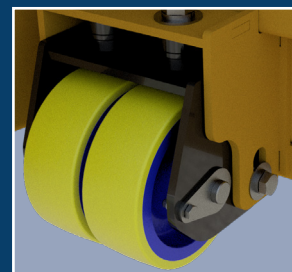

Adjustable wheels

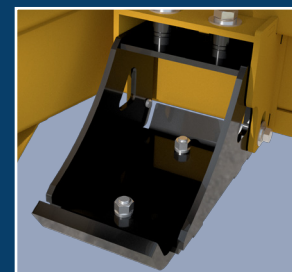

Adjustable skid shoes with bolted soles in Hardox 450 steel

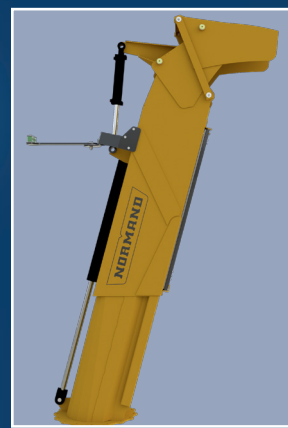

Telescopic industrial chute for truck loading

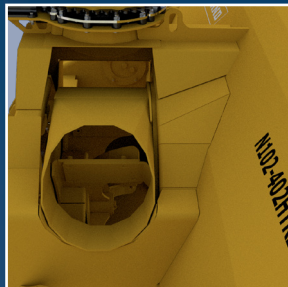

Right exit of the rotary drum

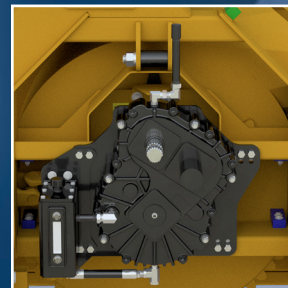

Auxiliary tank with oil level N102-342HTRI to N120-342HTRI



Forced lubrication system with oil level

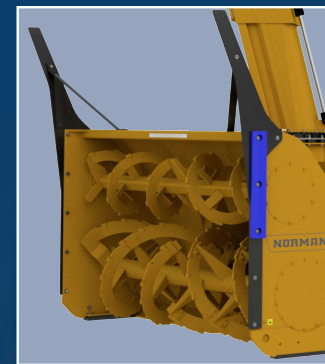

Fixed lateral blade in Hardox 450 steel and truck diverter



Directional hydraulic lateral blades in Hardox 450 steel and truck diverter

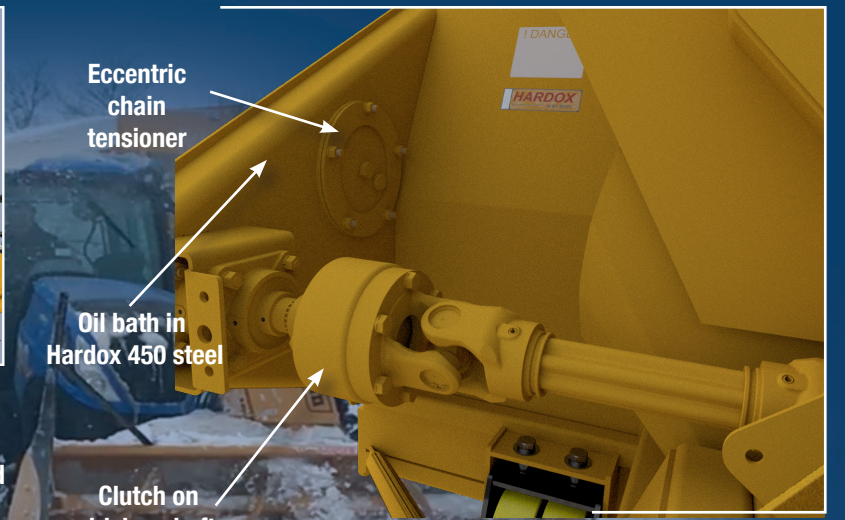

Eccentric chain tensioner

Oil bath in Hardox 450 steel

Clutch on driving shaft



Hydraulic motor for rotary drum with reducer and protected by a cushion valve

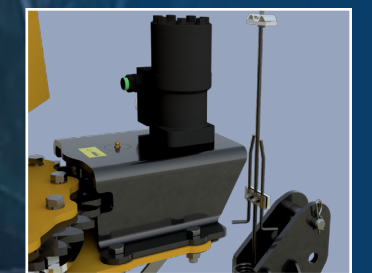

Hydraulic motor for chute with reducer and protected by a cushion valve



Guardrail diverter and sidewalk diverter

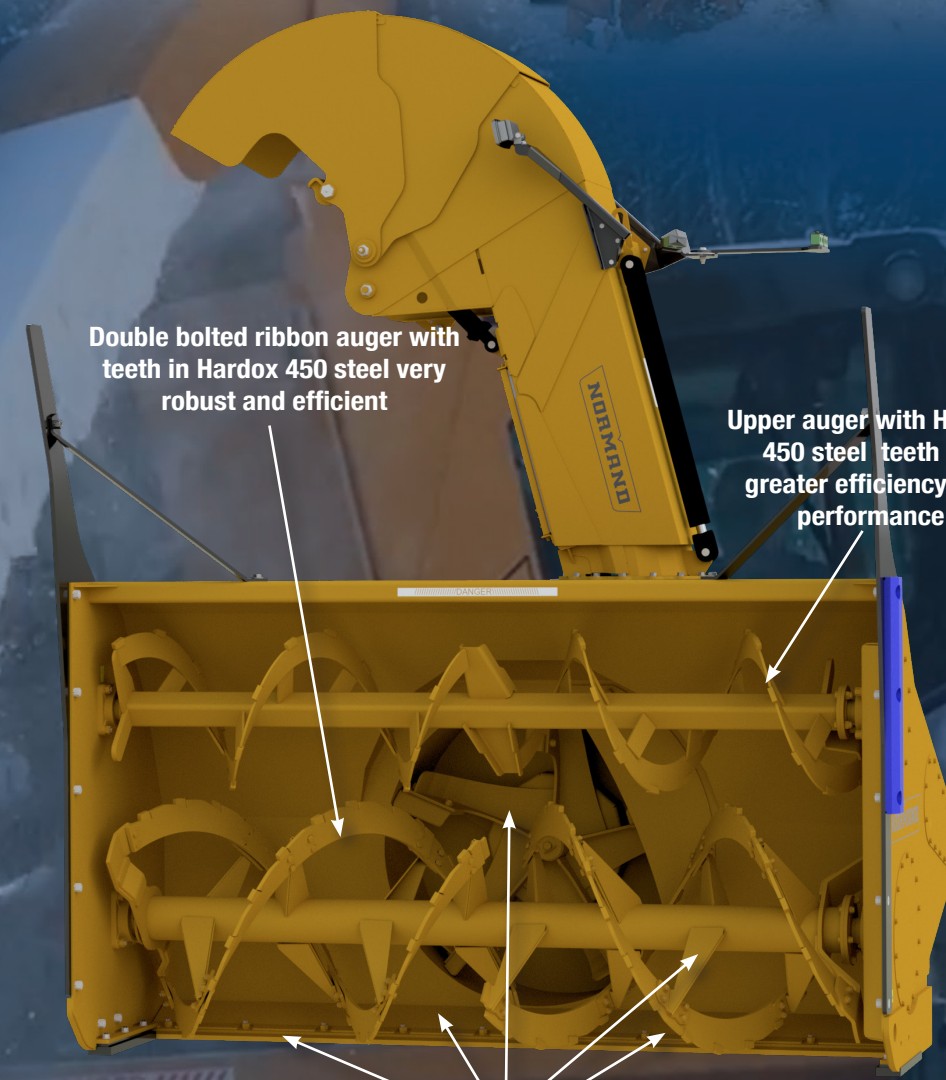

Double bolted ribbon auger with teeth in Hardox 450 steel very robust and efficient

Upper auger with Hardox 450 steel teeth for greater efficiency and performance

Reversible cutting edge, triple bottom, impeller, auger structure and full flight auger teeth in Hardox 450 steel.

Because we want our industrial snowblowers to be both sturdy and lightweight, we use ultra high-quality Hardox 450 steel to manufacture the most heavy-duty components.

Compare to standard steel, Hardox 450 is about 4.5 times harder and more wear-resistant while also being 3.5 times more rigid. For instance, a 1/4" thick Hardox 450 plate is the equivalent of a 3/4" thick standard steel plate.